

EXOSEAL™

VASCULAR CLOSURE DEVICE

INSERT

Using fluoroscopy, verify the femoral artery's suitability for arteriotomy closure with the EXOSEAL™ VCD, including the insertion angle (30-45 degrees) of the vascular sheath introducer.

1. Insert the EXOSEAL™ VCD into the sheath, advance to the black marker band.
2. Retract the sheath back to the wirecowling.
3. Continue to retract the sheath compressing the green Indicator Wire Cowling against the white handle. A "click" will be heard.

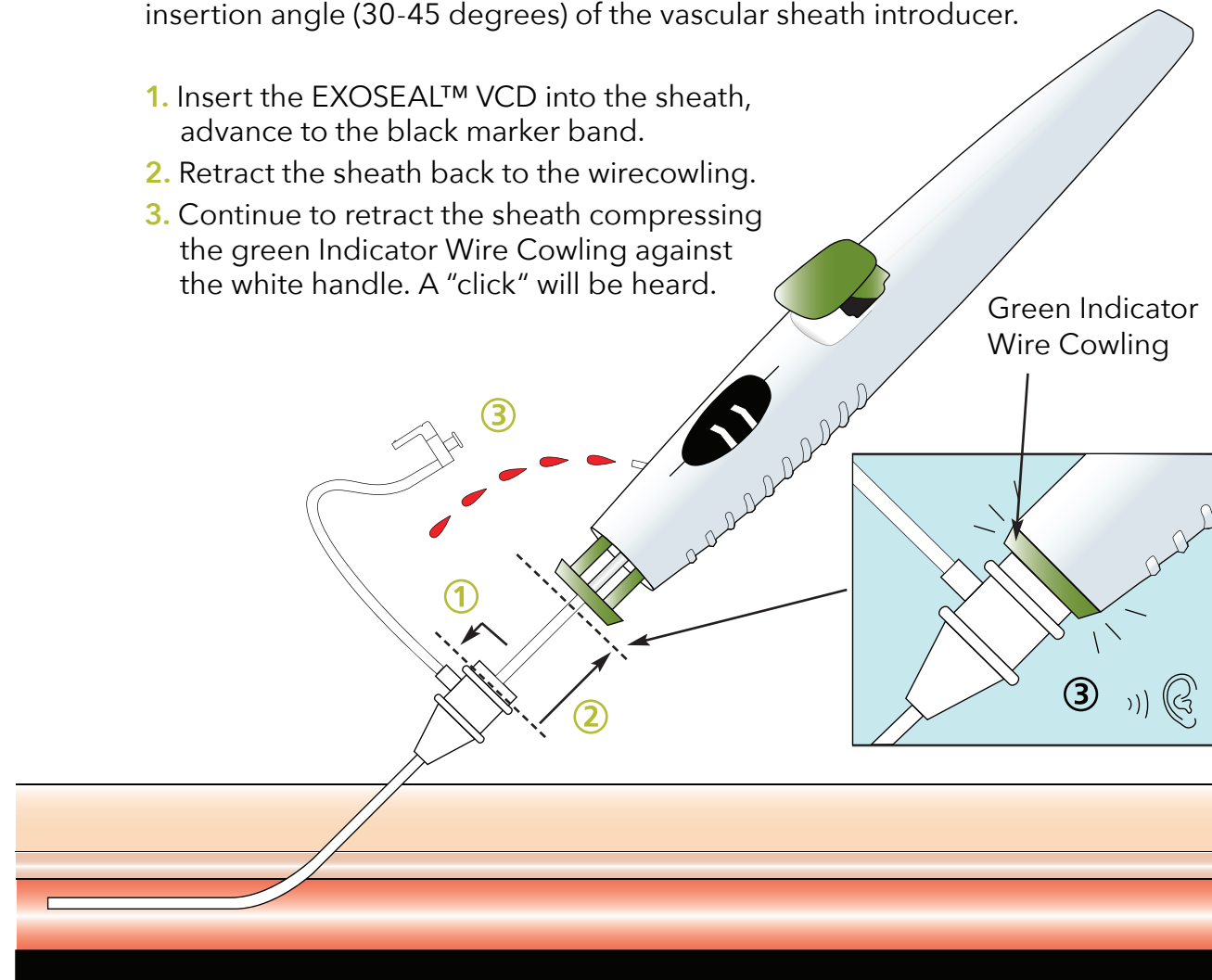

RETRACT

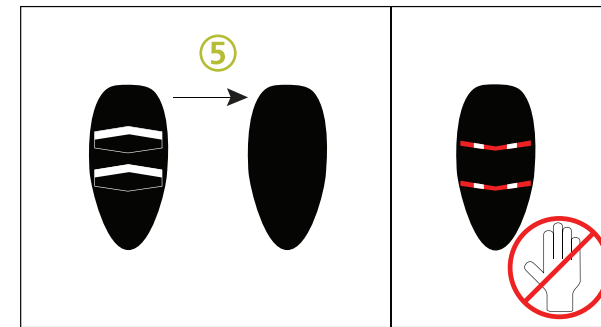

4. Retract the EXOSEAL™ VCD and sheath together with the left hand, maintaining a 30°-45° angle with the right hand. Watch the bleed-back indicator for a significant reduction in pulsatile flow.
5. When the flow significantly changes and becomes non-pulsatile, slow your speed of retraction and watch for the indicator window to change to all BLACK.

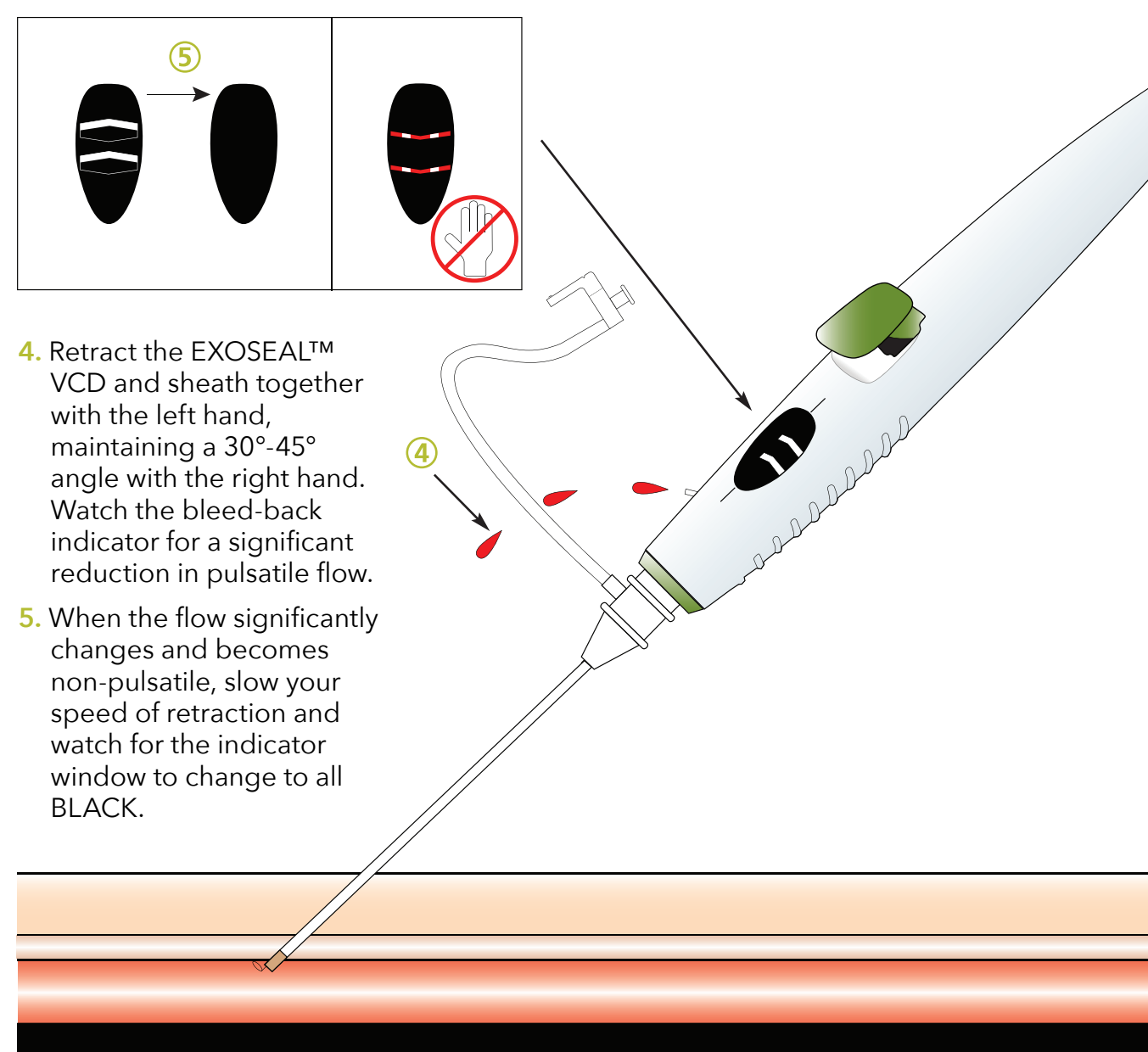

DEPLOY

6. Press the green plug deployment button fully into the white handle.
7. Remove the EXOSEAL™ VCD and sheath together.
8. Apply light non-occlusive finger tip pressure at the puncture site for 2 mins. Apply a sterile dressing and then observe site as per hospital protocol.

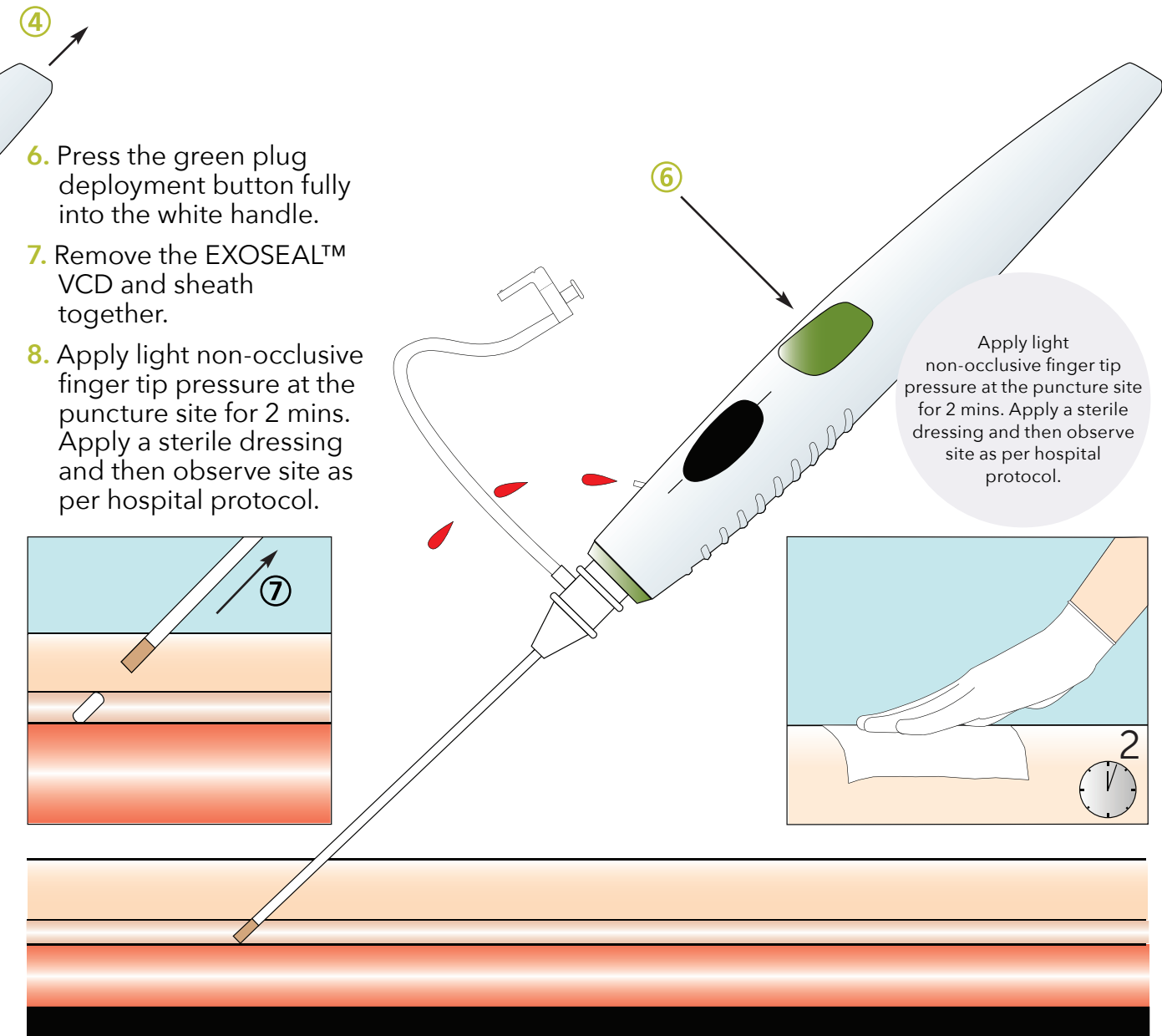

For Healthcare Professionals Only. Important information : Prior to use, refer to the instructions for use supplied with this device for indications, suggested procedure, warnings and precautions. As part of its continuous product development policy, Cordis reserves the right to change product specifications without prior notification. Please contact your Cordis representative for additional product availability information. CORDIS, Cordis LOGO and EXOSEAL are trademarks of Cordis and may be registered in the US and/or in other countries. © 2025 Cordis. All Rights Reserved. 100572036-3



Please refer to the complete "Instructions For Use" including all the steps to be followed during the procedure (IFU Section: Procedure) and the table of compatible sheaths before using the EXOSEAL™ Vascular Closure Device (Section XIII (Sheath Introducers Compatible with EXOSEAL Vascular Closure Device (VCD)))

